



# RBR-135

ROCK BOLTING RIG





# Designed for High-Performance Drilling, Built with Precision.

The Rhino RBR-135 Hydraulic Roof Bolter is engineered with advanced features that maximize productivity, increase uptime, and reduce operating costs in demanding underground mining applications. A high-power drilling system, optimized feed controls, and operator-focused technology enable faster drilling cycles and exceptional efficiency in tunnel development and ground support operations.



1. Automotive-style climate control system with adjustable air vents helps keep windows clear and the cab comfortable.
2. Advanced LCD monitor provides intuitive access to a wide range of operational, drilling, and diagnostic data and functions.
3. Ergonomically designed controls within easy reach deliver smooth, precise operation, reducing operator effort while ensuring reliable performance during drilling activities.

## ENGINE AND POWERTRAIN ( CARRIER )

Engine brand	RHINO RBR 60T / Cummins QSF2.8
Engine power kW (HP) @ RPM	60 (80) @ 2,500 / 56 (75) @ 2,500
Emissions certification	Euro Stage III
Transmission and steering type	100% hydrostatic assisted transmission and steering
Exhaust after-treatment system type (DPF / SCR)	Catalytic converter / Muffler
Axle type	Front and rear wet-type axles
Maximum gradeability (%)	14°
Approach angle (°)	20 / 20
Departure angle (°)	17 / 17
Tires (in)	9.00R20 / 9.00R20
Fuel tank L (gal)	70 (18.49)
Stabilizers	2 extendable front and 2 rear
Optional altitude configuration	Plateau type for over 3000 m a.s.l.

## HYDRAULIC SYSTEM

Power unit (Powerpack) kW (HP)	55 (73.76)
Pump type	Pumps for impact, positioning, propulsion and rotation
Maximum pressure bar (psi)	220 (3190.83)
Hydraulic tank reservoir / capacity L (gal)	180 (47.55)
Pressure filtration (µm)	10 / 10
Hydraulic oil cooler kW (HP)	Stainless steel water cooler
Hydraulic protection	Low level indicator with shutdown, oil temperature visual indicator (Oil temp gauge) and thermostat switch, filter indicator

## DIMENSIONS AND WEIGHT

Total / transport length mm (ft)	10543 (34.59)
Chassis length mm (ft)	6238 (20.47)
Transport width mm (ft)	2074 (6.80)
Width with stabilizers mm (ft)	2286 (7.50)
Transport height mm (ft)	2132 (6.99)
Operating height mm (ft)	2868 (9.41)
Wheelbase mm (ft)	3087 (10.13)
Ground clearance mm (in)	331 (13.03)
Inner turning radius mm (ft)	3146 (10.32)
Outer turning radius mm (ft)	5921 (19.43)
Internal / extended vertical coverage mm (ft)	1046 (3.43)
Maximum absolute height reach mm (ft)	6395 (20.98)
Minimum chassis structural height mm (ft)	1684 (5.52)
Beam frontal projection in transport mm (ft)	1439 (4.72)
Drilling depth below ground level mm (ft)	732 (2.40)
Maximum forward horizontal boom reach mm (ft)	7709 (25.29)
Canopy width mm (ft)	1228 (4.03)
Lower horizontal coverage radius mm (ft)	5019 (16.47)
Total operating weight kg (lb)	13500 (29762.41)

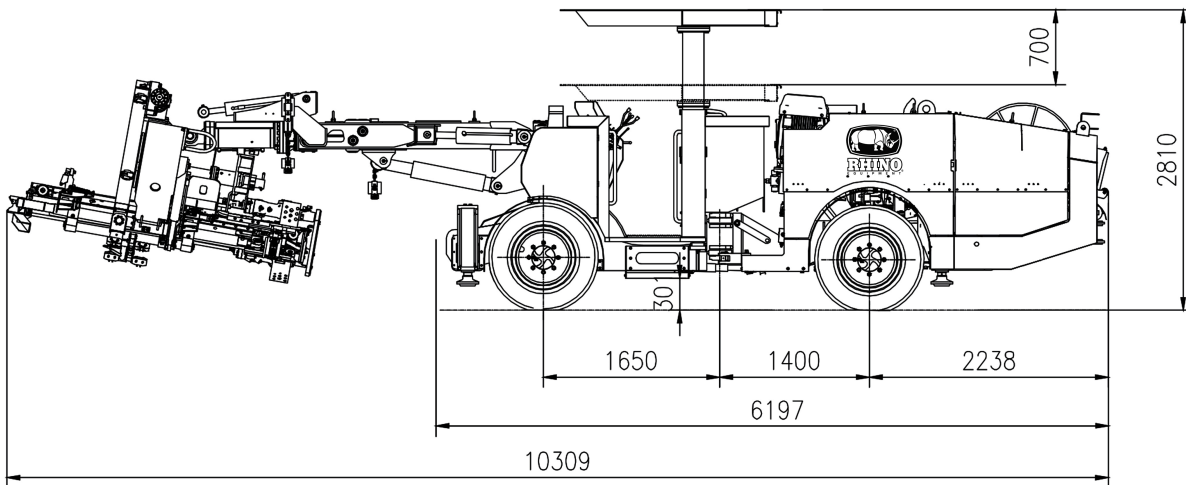

Equipment specifications and images may change without notice from Rhino Equipment Group Inc.

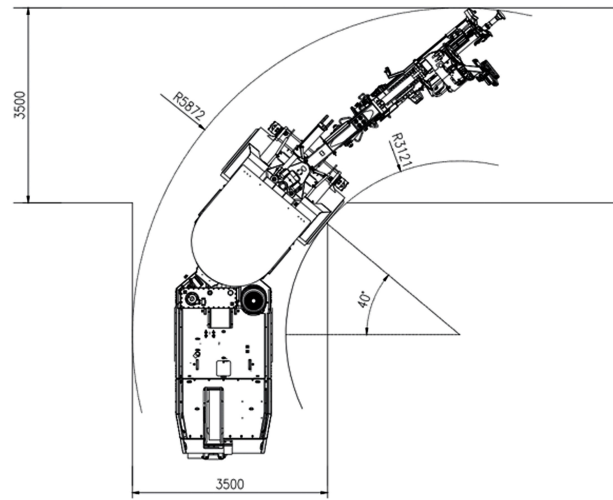
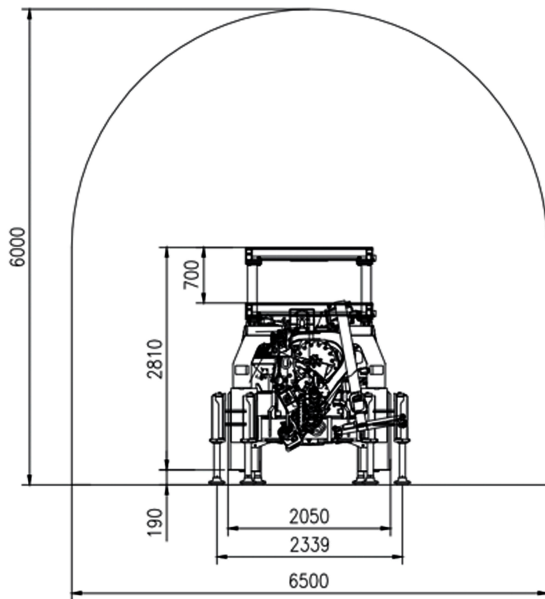

## DRIFTER (ROCK DRILL)

Drill model	M8B/D or M10B/D
Impact power kW (HP)	8 (10.73) or 10 (13.41)
Percussion pressure bar (psi)	15 (217.56) or 16 (232.06)
Percussion frequency Hz (bpm)	55 - 65 (3300 - 3900) or 53 (3180)
Rotation speed (rpm)	300 / 300 or 300 / 300
Rotation torque Nm (lb-ft)	401 (295.76) or 482 (355.50)
Shank adapter (Shank)	R32 / R32
Anti-jamming technology	Classic direct hydraulic control with anti-jamming function
Drill weight kg (lb)	71 (156.53) or 103 (227.08)

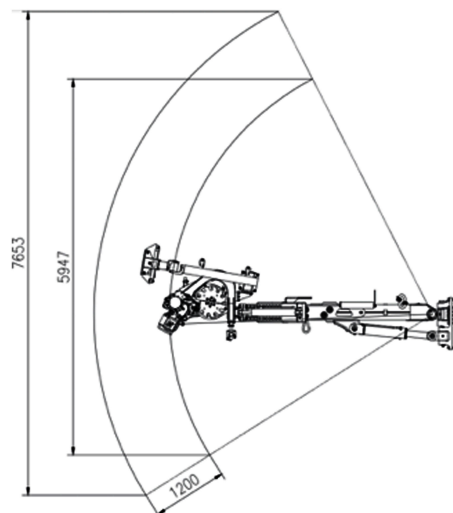
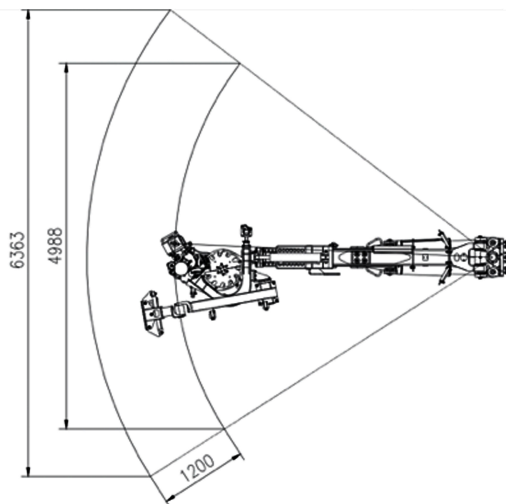

Equipment specifications and images may change without notice from Rhino Equipment Group Inc.

## BOOM AND FEED BEAM (INCLUDES BOLTING HEAD)

Module / boom model	BU25 or BU25F or BU25D
Number of booms	1
Boom telescopic extension mm (ft)	1200 (3.94)
Boom lateral swing (°)	±38 / ±38
Beam rotation / Roll-over (°)	±180 / ±180
Feed compensation mm (in)	410 (16.14)
Propulsion / feed force kN (lbf)	7.5 (1686.07)
Number of stingers	1 (Upper support stinger integrated into the bolting beam)
Drilling diameter mm (in)	32 - 51 (1.26 - 2.01) or 32 - 64 (1.26 - 2.52)
Hole depth mm (ft)	2185 (7.17) or 1950 (6.40) or 2460 (8.07)
Drill rod length mm (ft)	2475 (8.12) or 2175 (7.14) or 2700 (8.86)
Drilling speed m/min (ft/min)	0.8 - 2 (2.62 - 6.56)
Bolt length mm (ft)	2000 (6.56) or 1800 (5.91) or 2200 (7.22)
Bolt thread pitch / thread type	R32 / R32
Bolt loader capacity (Units)	10 (Split set) or 10 (Resin) or 6 + 6 (Combined simultaneously)
Compatible bolt types	Split set or resin bolts
Full bolting cycle time min (s)	2 - 3 (120 - 180)
Resin / grout injection system type	Synchronized with mesh handling arm
Water/air drill flushing system	Yes
Head automation	Integrated resin transport system synchronized with mesh handling arm

## APPLICATION AND SEGMENT

Drilling type	Rock bolting
Min. working coverage m × m (ft × ft)	3.5 × 3 (11.48 × 9.84)
Max. working coverage m × m (ft × ft)	6 × 6 (19.68 × 19.68)
Maximum coverage area m <sup>2</sup> (ft <sup>2</sup> )	32 (344.45)
Tunnel design section mm (ft)	6000 × 6000 (19.68 × 19.68)
Gallery crossing width mm (ft)	3500 (11.48)
Target segment	Small to medium sized galleries

## WATER AND AIR SYSTEM

Compressor type	Screw type
Compressor power kW (HP)	5.5 (7.38)
Air flow rate m <sup>3</sup> /min (L/s / cfm)	0.70 (11.6 / 24.58)
Air pressure bar (psi)	8 (116.03)
Water pump type	Centrifugal
Pump power kW (HP)	1.5 (2.01)
Water flow rate L/min (gpm)	50 (13.21)
Maximum water / washdown pressure bar (psi)	25 (362.59)

## AUTOMATION AND DIGITAL SYSTEMS

Control system	Classic direct hydraulic control
Operation type	Manual electro-hydraulic
HMI automation	Digital voltage and current meters
Bolting cycle automation	Yes



Equipment specifications and images may change without notice from Rhino Equipment Group Inc.

## ELECTRICAL SYSTEM

Installed power kW (HP)	62 (83.14)
Main electric motor kW (HP)	55 (73.76)
Voltage / Frequency V / Hz	380 / 50
Starting method	Star / Delta
Cabinet protection (IP)	Built-in phase sequence indicator
Cable reel / Length m (ft)	90 (295.28)
Electrical insulation monitoring device (Ground Fault)	Yes
Electric battery V (AH)	12 - 120

## CAB, ERGONOMICS AND SAFETY

Cab / canopy certification (ROPS / FOPS Level II)	FOPS Level II Approved
Operator seat	Fixed seat
Cab type	Protective canopy
Roof adjustment range / Max. coverage height mm (ft)	2110 to 2810 (6.92 to 9.22)
Cab noise level dB(A)	120 / 120
Mesh Handler	Hydraulic cylinder-operated mesh handling arm
Electrical protection	Thermal overload protection, phase sequence, 300VA transformer
Fire suppression system / Portable extinguisher	Portable extinguisher (Standard) / Automatic fire suppression system (Optional)
Horn (Claxon) and Reverse alarm	Yes
Strobe lights	8 halogen transit lights, brake light and warning lights
Exhaust catalyst and muffler	Yes
Chassis leveling element	Spirit level indicator